

Royal Docks

Equalising Opportunity in Public Space

Dan Bridge

15 July 2020



MAYOR OF LONDON



The landscape of the Royal Docks is a result of the subsequent layering of infrastructure - docks, rail, roads, and runways - creating a fragmented infrastructural landscape: a landscape defined by operations rather than human experience



Royal Docks Public Realm Framework

5th Studio were appointed in 2019 to lead on the Royal Docks Public Realm Framework to:

- Develop a **vision** for the public realm in the Royal Docks
- Develop a **coherent design character**
- Increase soft landscaping i.e. **greening**
- Identify key **intervention sites**
- Identify priority networks and **connections** to improve



Creating the Royal Docks Public Realm Framework

Stakeholder & Community Engagement
Pop-up Events - Meetings - Thematic Workshops



Previous studies and strategies to support inclusivity and accessibility...

These include, among others:

- Space Syntax Flows Analysis, 2018-19
- Witherford Watson Mann, The Royal Docks Local Movement And Infrastructure Study, 2012 (updated 2018)
- Current strategic planning documents
- Mayor’s Transport Strategy
- LBN Cycling Strategy
- Royal Docks Local Transport Design Study, 2015
- TfL’s Healthy Streets approach

Space Syntax study, 2018-19



Engaging communities in the public realm so far...

**LFA Custom House
Design Charrette**
Dec 18 – Jan 19

**Albert Island
Marina Workshops**
May 2019

**Royal Docks 2019
engagement programme:
'Join the Conversation'**
Jul-Oct 2019

**North Woolwich Rd
Initial engagement**
Autumn 2019

**Project-specific
engagement**
Including Thames
Barrier Park & Tree
Planting Programme

Design Guides input
summer 2020
(ongoing)

- Custom House to Thames stitch
- RV Dock loop stitch
- Water activation principles
- RVD intervention site

- Beckton to North Woolwich stitch
- Water activation principles

- Overarching vision and principles
- Stitches, water, landscape, places
- Intervention sites approach
- Site specific suggestions

- NWR intervention site

- Site-specific suggestions
- Landscape approach

- Input shaping principles, guidelines & usage needs for different spaces



Public Realm Framework: key principles

ACTIVATE THE WATER



STITCHES / CONNECTIONS



DIVERSE PLACES

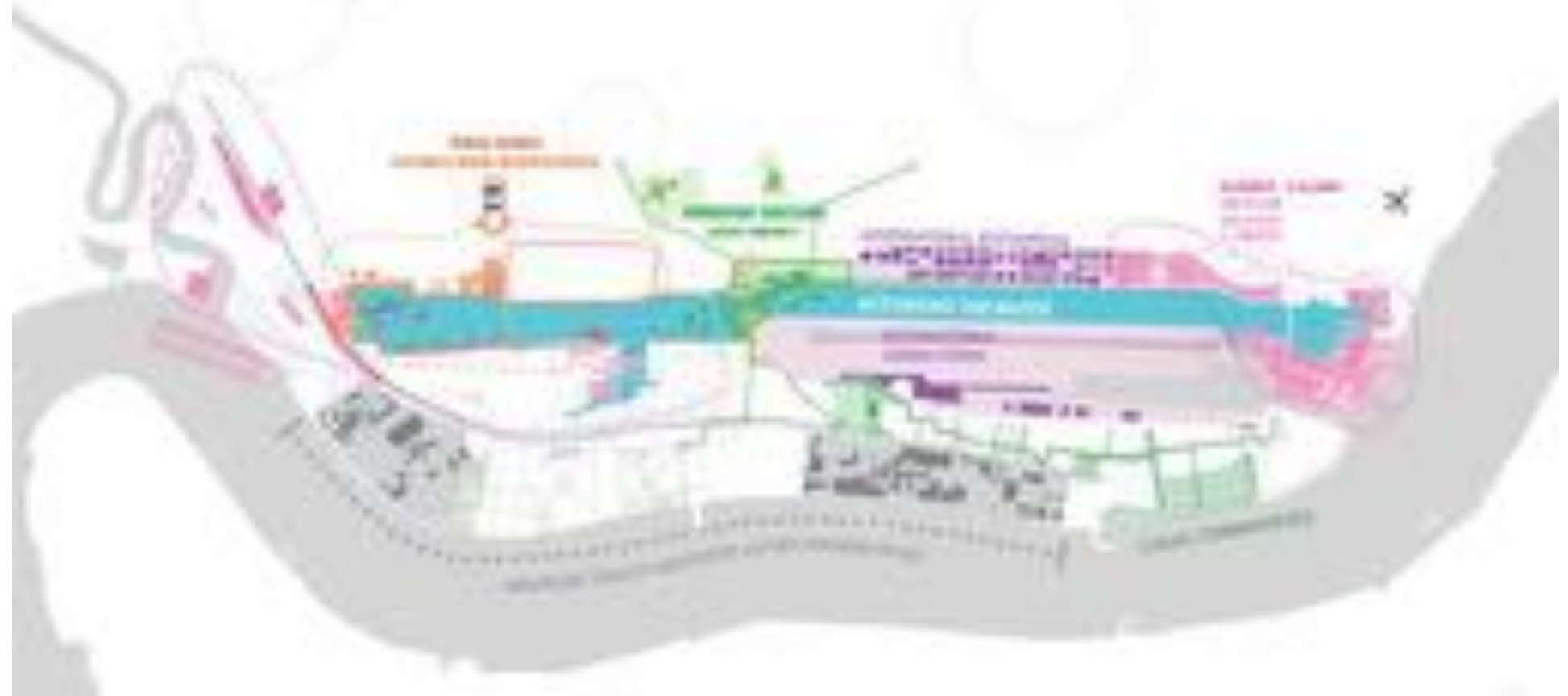

LANDSCAPE CHARACTERS



Public Realm Framework: intervention sites

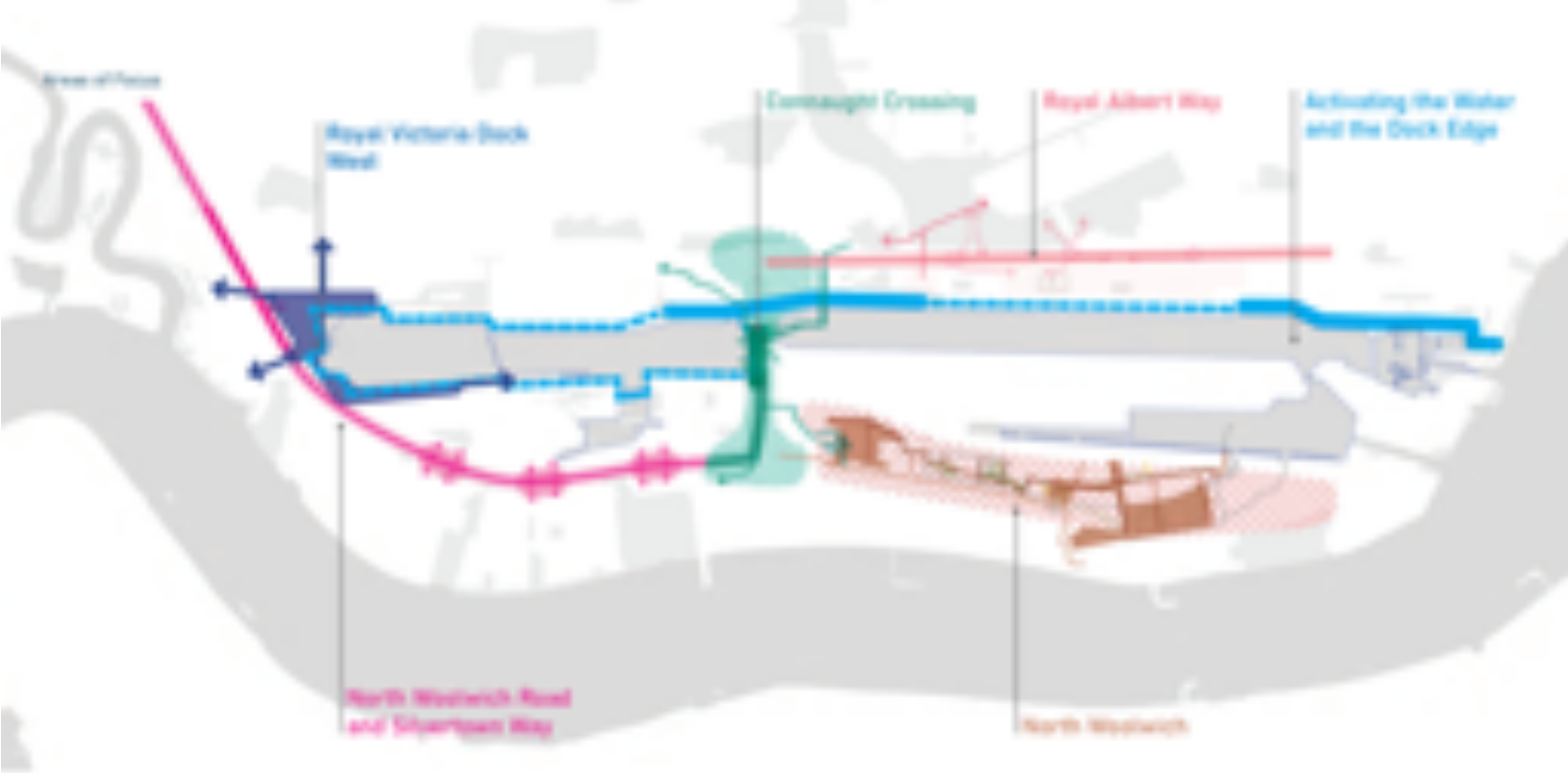

What are the next steps for the Public Realm Framework?

- Royal Docks Public Realm Framework
- Royal Docks Design Guides
- Cycling & Walking Action Plan
- **Accessibility & Inclusive Design Review**

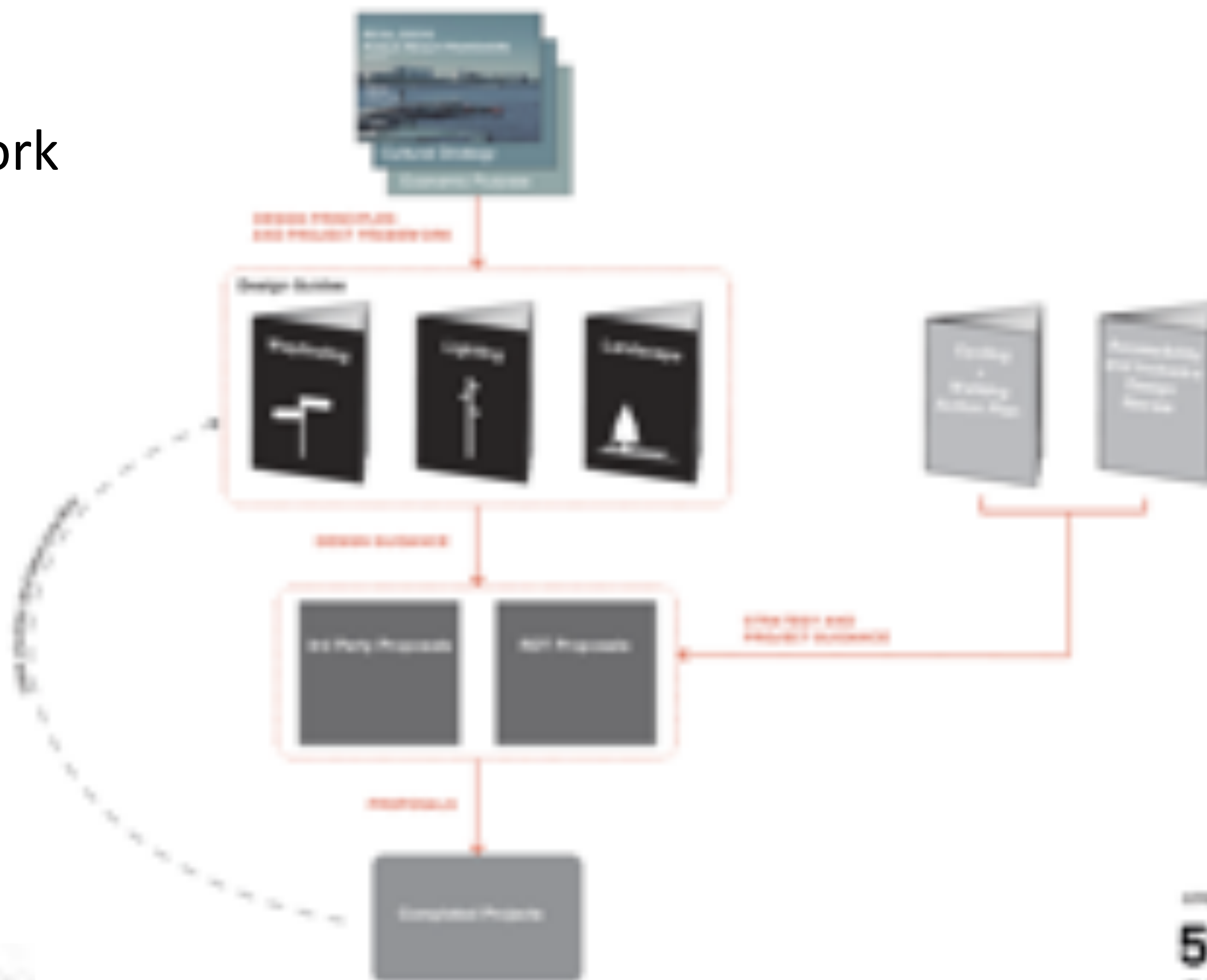

Public Realm Design Guides

A shared resource to create a coherent landscape across the Royal Docks



Landscape



Lighting



Wayfinding



Cycling



Royal Docks Accessibility Advisor

- Identify the key challenges and opportunities in the Royal Docks to create public spaces that are accessible and inclusive for all.
- Design review of RD strategic public realm documents and appraisal from an accessibility and inclusive design perspective.
- Make evidence-based recommendations on how to adjust the design approach to enhance inclusivity outcomes, and create public spaces that are representative of the diverse communities that visit and live in the Royal Docks, Newham and London.
- Develop a process to assess inclusive design in future public realm schemes in the Royal Docks.

Thank You!

